

Courtesy Of Bob Maskell Of Royal LePage Arteam Realty

\$299,900 - 2404 4 Augustine Crescent, Sherwood Park

MLS® #E4427744

\$299,900

2 Bedroom, 2.00 Bathroom, 953 sqft
Condo / Townhouse on 0.00 Acres

Aspen Trails, Sherwood Park, AB

Gorgeous TOP (Nine foot ceilings) floor executive apartment with Espresso cabinets and granite countertops! Ensuite laundry and 2 titled parking stalls. Wrap around deck with SW exposure and roughed in for A/C....Beautiful!! Propane BBQ's only



Built in 2015

Essential Information

MLS® #	E4427744
Price	\$299,900
Bedrooms	2
Bathrooms	2.00
Full Baths	2
Square Footage	953
Acres	0.00
Year Built	2015
Type	Condo / Townhouse
Sub-Type	Lowrise Apartment
Style	Single Level Apartment
Status	Active

Community Information

Address	2404 4 Augustine Crescent
Area	Sherwood Park
Subdivision	Aspen Trails
City	Sherwood Park

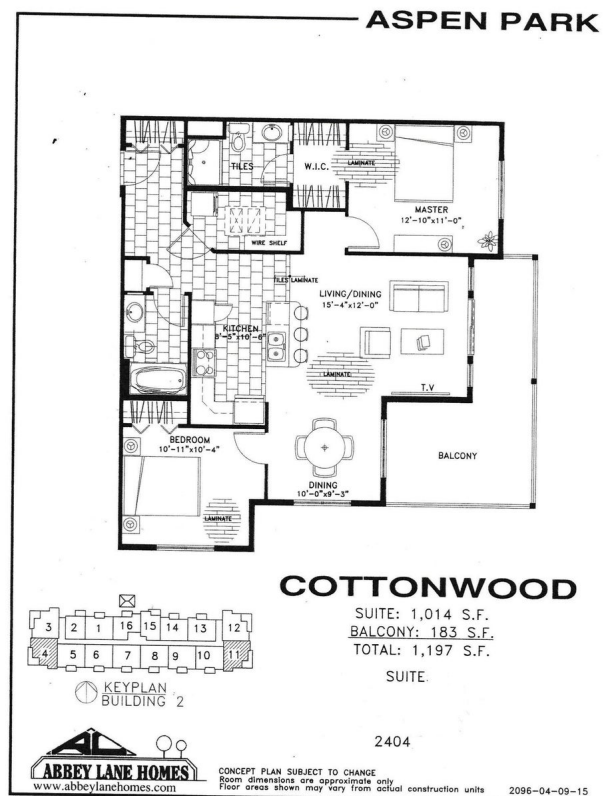

County ALBERTA
Province AB
Postal Code T8H 0X8

Amenities

Amenities Exterior Walls- 2"x6", No Animal Home, Parking-Plug-Ins, Parking-Visitor, Rental Pool Option
Parking 2 Outdoor Stalls

Interior

Interior Features ensuite bathroom
Appliances Dishwasher-Built-In, Dryer, Refrigerator, Stove-Electric, Washer
Heating Baseboard, Natural Gas
of Stories 4
Stories 4
Has Basement Yes
Basement None, No Basement

Exterior

Exterior Wood, Asphalt, Stone, Vinyl
Exterior Features Cul-De-Sac, Flat Site, Golf Nearby, Public Swimming Pool, Public Transportation, Schools, Shopping Nearby
Roof Asphalt Shingles
Construction Wood, Asphalt, Stone, Vinyl
Foundation Concrete Perimeter

Additional Information

Date Listed March 27th, 2025
Days on Market 15
Zoning Zone 25
Condo Fee \$463

DATA IS DEEMED RELIABLE BUT IS NOT GUARANTEED ACCURATE BY THE REALTORS® ASSOCIATION OF EDMONTON. COPYRIGHT 2025 BY THE REALTORS® ASSOCIATION OF EDMONTON. ALL RIGHTS RESERVED. Trademarks are owned or controlled by the Canadian Real Estate Association (CREA) and identify real estate professionals who are members of CREA (REALTOR®, REALTORS®) and/or the quality of services they provide (MLS®, Multiple Listing Service®)

Listing information last updated on April 11th, 2025 at 1:47am MDT